

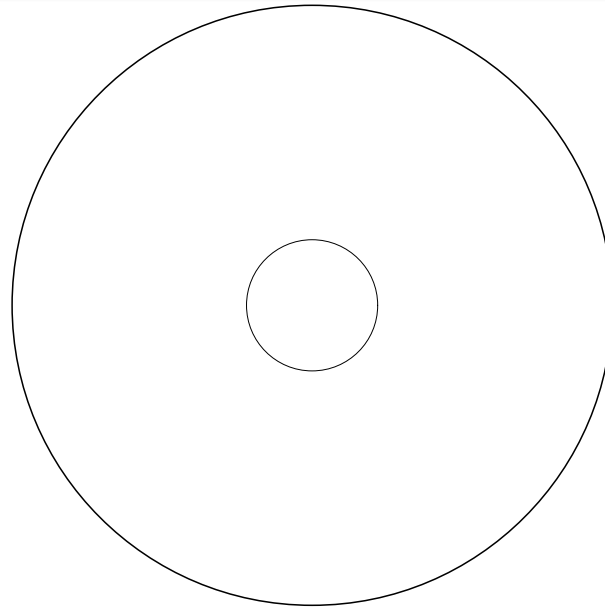

### Equipment Alert

Between each procedure complete manufactures instructions for "Infection Control / Sterilization found in the documentation included with the handpieces. Failure to do this will cause premature failure of handpieces.



### Adjustments...

- A) Rotate water needle valve until desired flow is achieved.
- B) Adjust drive air using a screwdriver.
- C) Move toggle toward water bottle that will supply water.

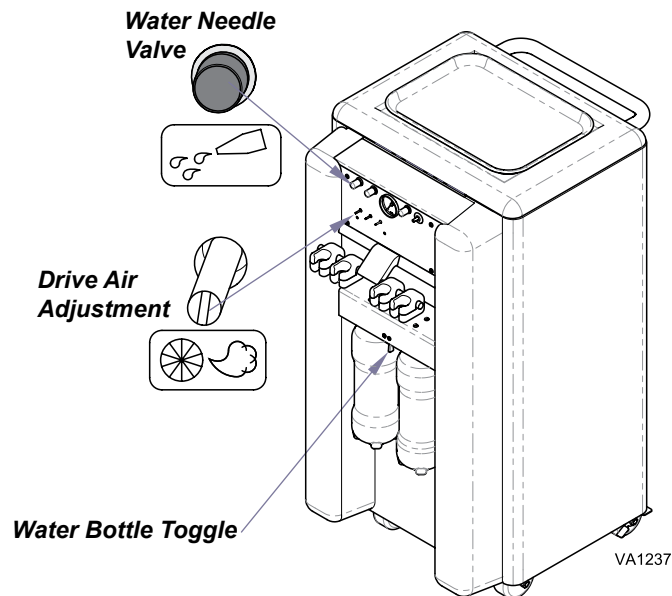

### To activate warranty:

Insert CD, then select Product Registration from the menu.

## Annual Maintenance Kits



### Bronze Muffler

Order#: 002-1143-00



### Filter for Plastic Muffler

Order#: 002-1149-00



### Regulator Filter with O-Ring

Order #: 002-1144-00

### Calling for Service

If service is required, contact Midmark directly:

1-800-Midmark (1-800-643-6275)

8:00am until 5:00 pm Monday through Friday (EST)



## Operating & Care Guide VetPro® 1000

Model Number:   
 Serial Number:

Dealer Information:

Purchase Date:

003-1880-00 Rev G

The operation of the VetPro® 1000 is restricted to use by veterinary professionals.

This guide outlines basic care and maintenance of the VetPro® 1000. The enclosed CD provides additional instructions on operation and care. If service is required, contact your authorized Midmark dealer.

Midmark Corporation  
 60 Vista Drive  
 Versailles, OH 45380-0286  
 Phone: 937-526-3662  
 Fax: 937-526-5542  
 www.midmark.com



Because we care.

© Midmark Corporation 2008

### To Flush Handpieces...

- Remove all handpieces that use water.
- Open water needle valve.
- Hold the handpieces over a container and depress foot control.
- Allow water to run 20 to 30 seconds.
- Install newly disinfected handpieces.
- Refill water bottle.

Note: When performing "Flush Handpieces" procedure at the end of the day. Refer to: User's Guide 003-1879-00 on CD or [www.Documark.com](http://www.Documark.com) for procedure.)

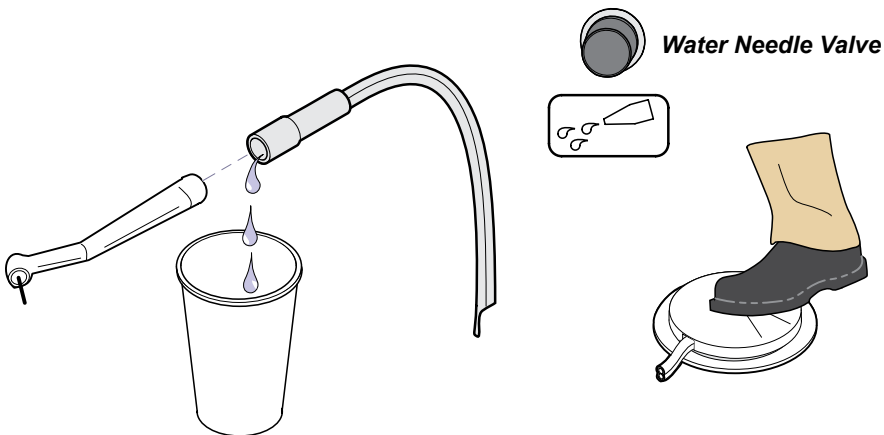

### To Fill Water Bottles...

- Move water bottle toggle to center.
- Remove water bottle and fill. (Distilled Water Is Recommended)
- Replace water bottle and move toggle toward filled water bottle.

Note: Water bottles should be checked in between each patient and filled if necessary.

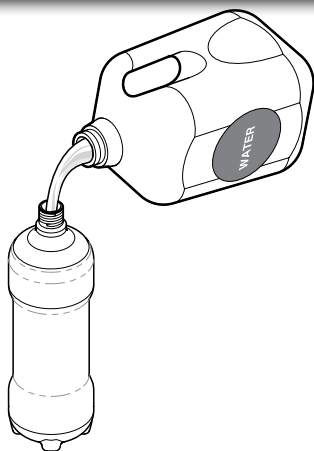

### To Drain Condensation from Air Tank...

- Turn power switch off.
- Position end of yellow tube so it drains into a container.
- Turn drain valve slowly to open.
- When no water is coming out, slowly close valve.

### To Drain Air Regulator...

Place a cloth under the regulator and depress the button until there is no water comes out.

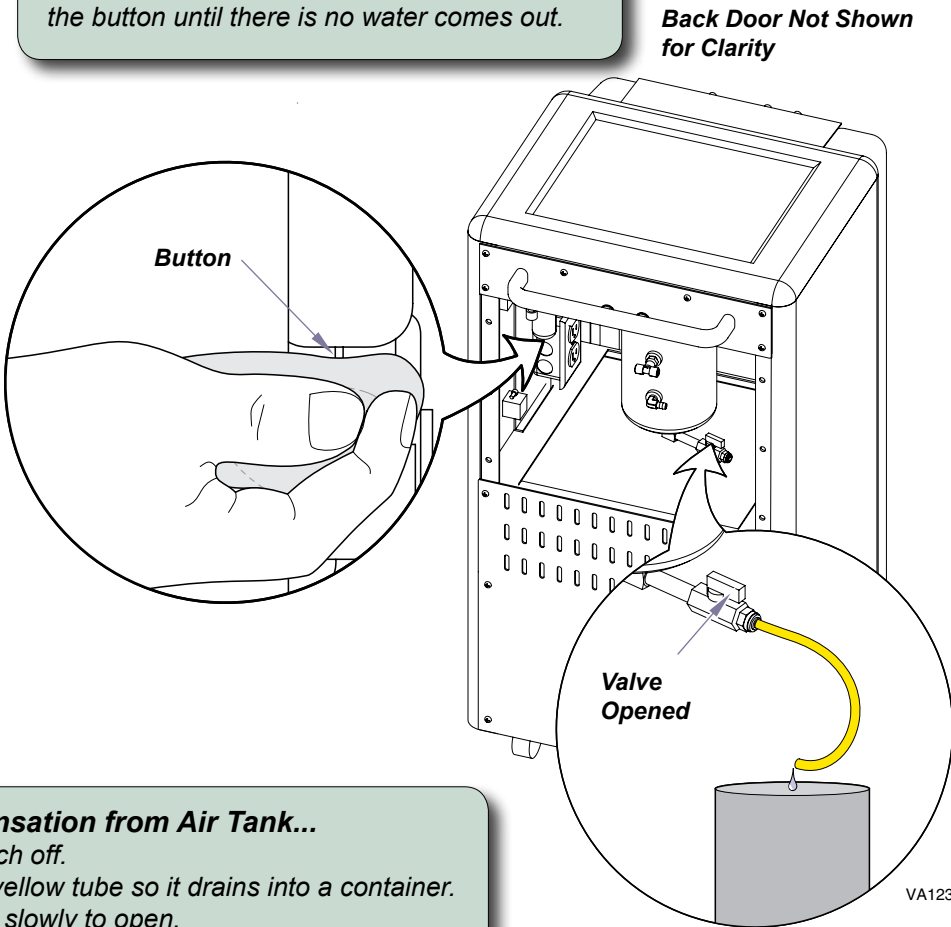

## After Each Procedure

### A. Clean.

Handpieces and syringe tip should be changed or disinfected between each patient according to manufacturer's instructions.

### B. Flush & Lubricate handpieces.

### C. Fill Water Bottles.

## Daily

### A. Empty Water System.

- Remove, empty and reinstall water bottles.
- Move water toggle valve to left side.
- Open water needle valves all the way.
- Hold Handpiece over a container and depress foot control until no water is coming out of the tubing.
- Hold air/water syringe over a container and depress the water button until no water is coming out.
- Move water toggle valve to right side and depress the water button on the syringe again.

### B. Drain Air Regulator.

### C. Drain Condensation from Air Tank.

### D. Clean System

- Disinfect handpieces according to manufacturer's instructions.
- Clean the exterior surfaces with a clean, lint free cloth, dampened with disinfectant. Do not drip any liquid into open vents, plugs or connectors. Dry the surfaces with a clean cloth or paper towel.

### E. Bleach Flush Handpieces.

(End of Day Only - Refer to: User's Guide 003-1879-00 on CD or [www.Midmark.com](http://www.Midmark.com) for procedure.)

### Adjustments...

- Rotate water needle valve until desired flow is achieved.
- Adjust drive air using a screwdriver.
- Move toggle toward water bottle that will supply water.

